



FOR LEASE
\$4.25/SF
MG TERMS

1243 E GARNER BAGNAL BLVD
STATESVILLE, NC

120,000 SQUARE FOOT WAREHOUSE OFF I-77

This 120,000 SF industrial facility offers a versatile space for various operation in a great location featuring 6 dock doors, 2 drive-in doors, and 3-phase power (208 & 480V), making it ideal for manufacturing or distribution. It includes 16,000 SF of 20-ft clear height space, 100,000 SF of 12-ft clear height space, and 4,000 SF of office space. Additionally, the facility is equipped with gas unit heaters for optimal climate control.



PHOTOS



FLOOR PLAN

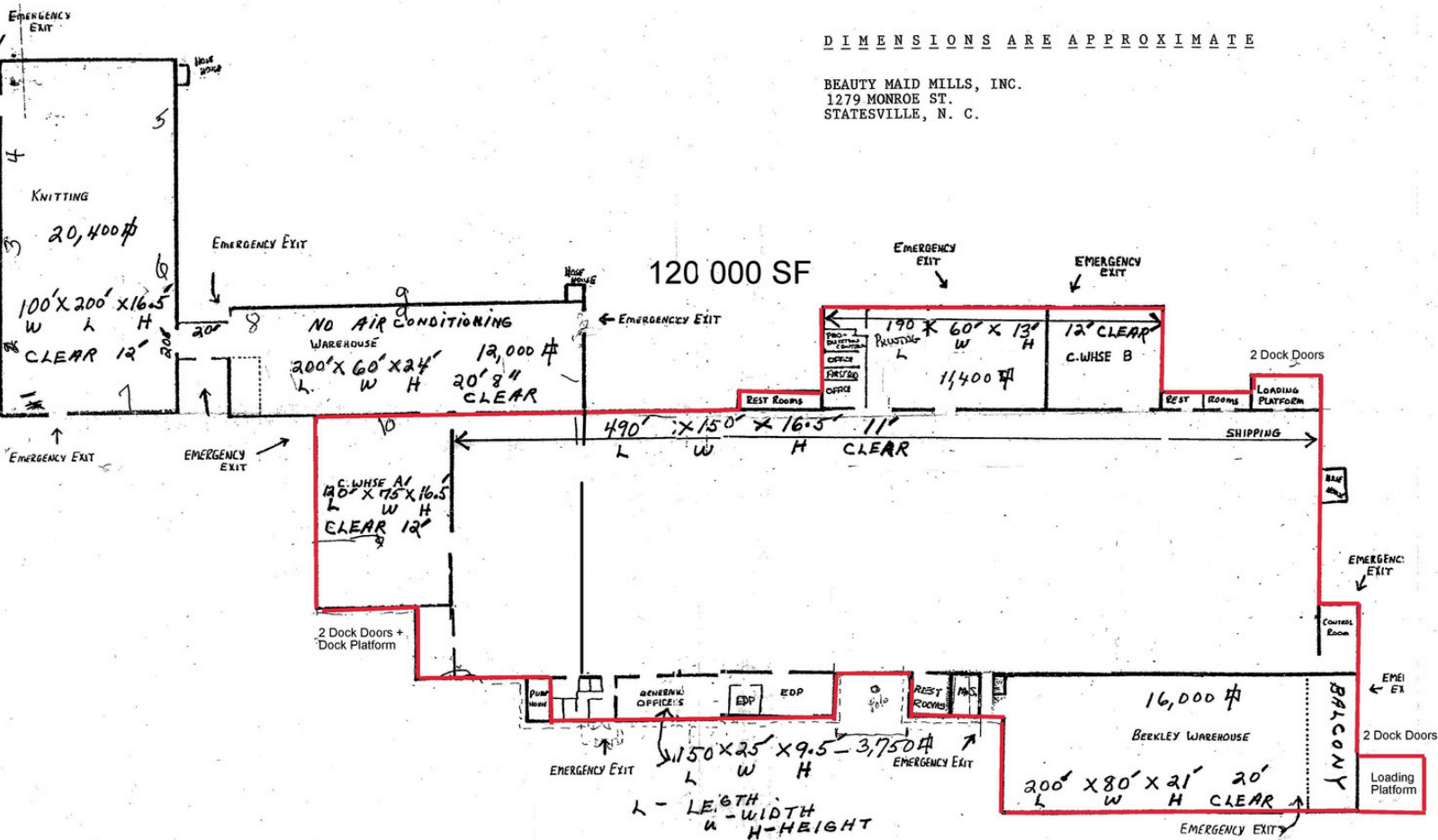

0.2 Miles From I-77

3-Phase Power
208v & 480v

6 Dock Doors
2 Drive-In Doors



0.2 Miles From I-77

3-Phase Power
208v & 480v

6 Dock Doors
2 Drive-In Doors



0.2 Miles From I-77

3-Phase Power
208v & 480v

6 Dock Doors
2 Drive-In Doors



4,000 SF Office

16,000 SF w/ 20ft Ceilings

100,000 SF w/ 12ft Ceilings

Gas Unit Heaters



4,000 SF Office

16,000 SF w/ 20ft Ceilings

100,000 SF w/ 12ft Ceilings

Gas Unit Heaters



4,000 SF Office

16,000 SF w/ 20ft Ceilings

100,000 SF w/ 12ft Ceilings

Gas Unit Heaters



CONTACT INFO

BARRETT MITCHELL
barrett@bhicp.com
(828) 322-1723

